

## HOW TO HANDLE PROBE FOR MODEL 6036

### 1. HOW TO HANDLE PROBE EXTENSION ROD

① When extension rod for probe is used for measurement, pinch the edge of the probe and pull slowly.

#### 【Notes on Handling】

- 1) If the extension rod is still secured when it is pulled, or if too much force is applied, the connection point can be damaged/broken.
- 2) The maximum weight that the extension rod can hold is 5kg; if more 5kg of weight is applied, the extension rod will no longer be covered by warranty.

#### ※Spec of Probe extension rod

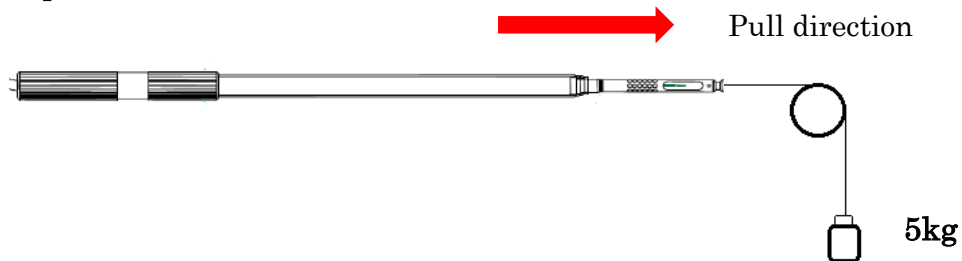

### 2. HOW TO HANDLE PROBE FLEXIBLE AREA (MODEL 6036)

NOTE: Please do not over-bend, or force the probe to bend beyond its limits. Flexible area should be secured within the tube (2) when not in use.

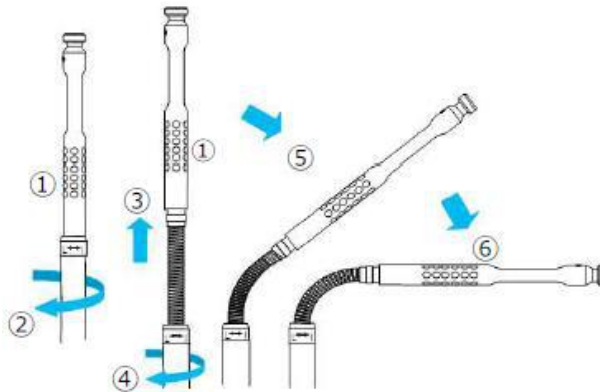

- 1) Hold area ① in place and turn piece ② in the direction shown to free the flexible extension piece.
- 2) Pull flexible area ③ and hold area ①. Turn extension rod to direction shown in ④ to lock the flexible extension out for use.
- 3) Bend slowly as shown in ⑤~⑥ picture shown above. Please bend this flexible area very slowly to avoid over-stressing the part.